

City of San Clemente
Building Division

DEMOLITION

INFORMATION BULLETIN

REQUIREMENTS AT THE SITE

- IF ASBESTOS IS DISCOVERED IN THE BUILDING DURING THE PROCESS OF DEMOLITION, IMMEDIATELY STOP ALL WORK AND NOTIFY:
 - ORANGE COUNTY FIRE AUTHORITY: (714) 573-6000
 - BUILDING DIVISION: (949) 361-6100DO NOT PROCEED WITH WORK UNTIL AUTHORIZED TO PROCEED BY THE ABOVE AGENCIES. For further information, contact offices of EPA (415) 947-8704 and/or AQMD (909)-396-2336. State Law requires that a contractor must be certified by the California State License Board (CSLB) and registered with the Division of Occupational Safety and Health (DOSH) if engaged in asbestos-related work.
- All glass must be removed from the structure before beginning demolition.
- Street drainage, drainage structures, natural drainage or diversion must not be obstructed.
- The contractor shall employ dust control measures during the demolition operation, including regular watering of the site as may be required.
- Combustible material must be removed from the site as demolition proceeds. Combustibles shall not be burned on the site.
- All debris not to be reused elsewhere must be taken to a legal dump.
- Lumber, boxes, barrels, bricks, stones, junk debris or similar materials stored on the site must be piled in an even and orderly manner upon racks elevated not less than 18 inches above the ground and away from walls of buildings or other structures, so that those materials will not afford a shelter or harborage for rats.
- Please note that provisions of sanitary facilities on your construction site is required by law. There shall not be less than one water closet for each 20 employees or fractional part thereof working at the site.
- All demolition activity in the City of San Clemente is limited by City Ordinance to the hours between 7:00 a.m. and 6:00 p.m., Monday through Saturday.
- After backfilling the excavation of underground tanks, submit the soil compaction report to the Engineering Division for approval.

CODE SECTIONS:

Demolition of structures is regulated by Chapter 33 of the Uniform Building Code.

INSPECTIONS AND DISCONNECTING SERVICES

- Notify Southern California Gas Company ("Gas Co") at (800) 427-2200 and San Diego Gas and Electric at (800) 411-7343 **in advance** to disconnect gas and electric services.
- Contact the City Utilities Division at (949) 366-1553, **48 hours in advance** to disconnect the water service and remove the water meter.
- Call the City Building Division at (949) 361-3129 before 4:00 p.m. for the following work day sewer cap inspection.

THIS BULLETIN SHALL NOT BE REMOVED FROM THE PLANS.

LEGEND OF ABBREVIATIONS

TC	TOP OF CURB	CONC	CONCRETE
WM	WATER METER	FG	FINISHED GRADE
FF	FINISHED FLOOR	S&W	SPIKE & WASHER
FS	FINISH SURFACE	PL	PROPERTY LINE
BLD	BUILDING	CL	CENTERLINE
SWK	SIDEWALK	T.B.M.	TEMPORARY BENCH MARK
FNC	FENCE		SURVEY REFERENCE ELEVATION
VAULT	UTILITY VAULT	SMH	SEWER MANHOLE
ELEC	ELECTRIC	BC	BEGINNING OF CURVE
FW	FACE OF WALL	EP	EDGE OF PAVEMENT
FNC	FENCE	COR	CORNER
TW	TOP OF WALL	TS	TOP OF STEP
LT STD	LIGHT STANDARD	AP	ANGLE POINT
PB	PULL BOX	CL	CENTERLINE
CHIM	CHIMNEY	MON	MONUMENT
GFF	GARAGE FINISHED FLOOR	FL	FLOWLINE
TC X	DRIVEWAY APPROACH	GAS	GAS METER
T.B.M.	TEMPORARY BENCH MARK	WM	WATER METER
		TEL PED	TELEPHONE PEDESTAL/RISER

SURVEY NOTES:

THE LOT LINES SHOWN ON THIS DOCUMENT WERE ESTABLISHED USING EXISTING MONUMENTS AND THE FOLLOWING RECORD DOCUMENTS; TRACT 3980 AND TRACT 3981

*THIS IS NOT A BOUNDARY SURVEY
THE LOT LINES SHOWN HEREON ARE FOR INFORMATION PURPOSES ONLY.

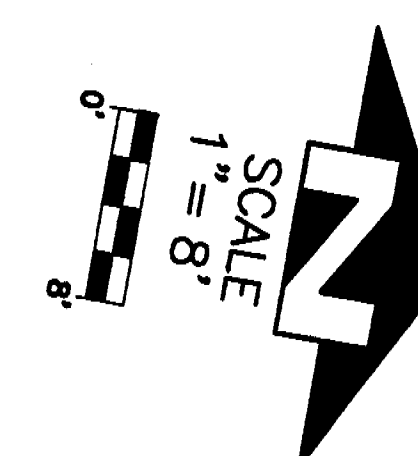

LEGAL DESCRIPTION:

LOT 1 OF TRACT 3981, IN THE CITY OF SAN CLEMENTE, COUNTY OF ORANGE, STATE OF CALIFORNIA

BENCH MARK

ELEVATION DATUM: ASSUMED 100.00 AT EXISTING FINISHED FLOOR

DEMOLITION PLAN

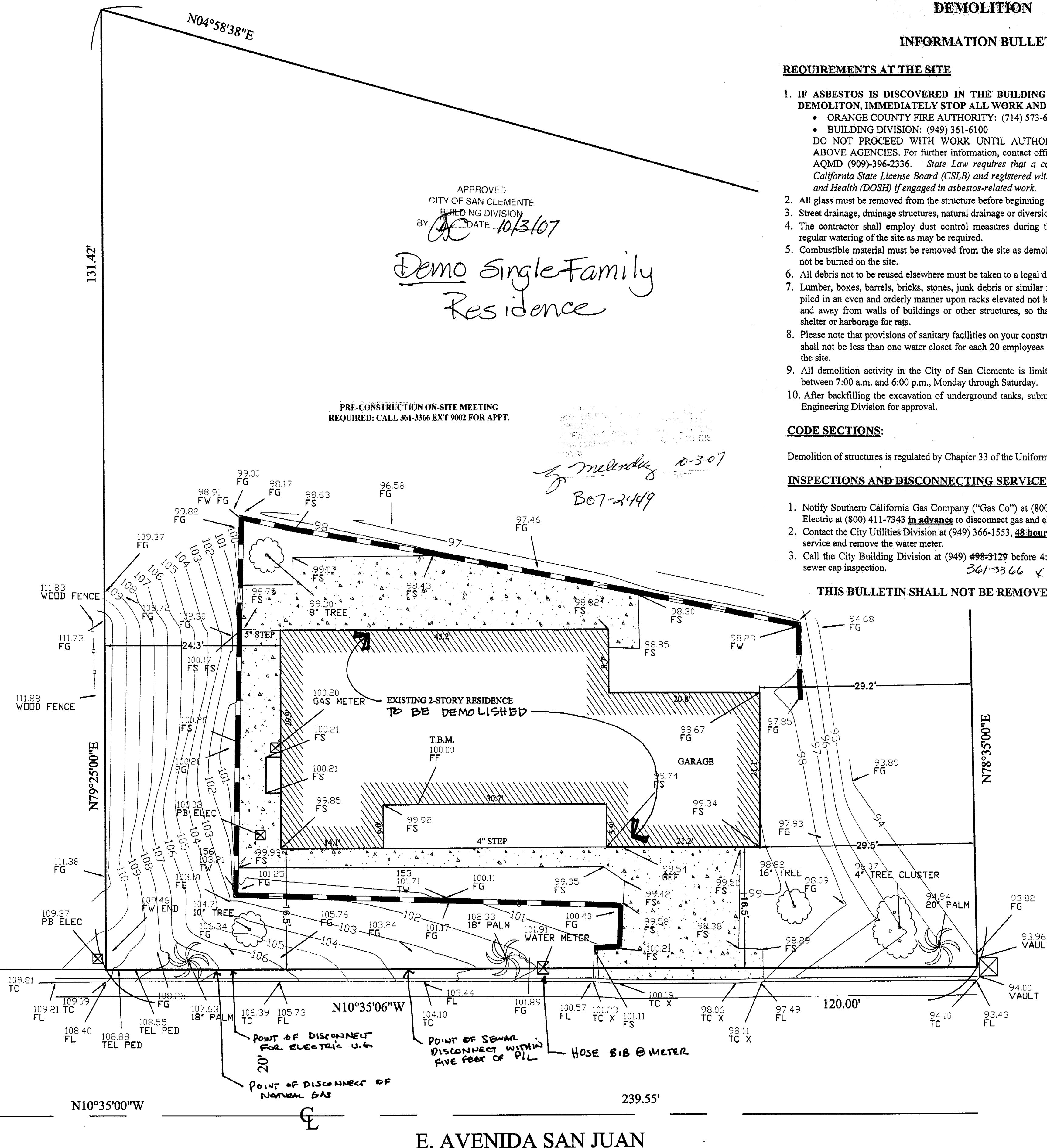

SOUTH COAST SURVEYING
3214 CLAY ST.
NEWPORT BEACH, CA
(949) 631-8840

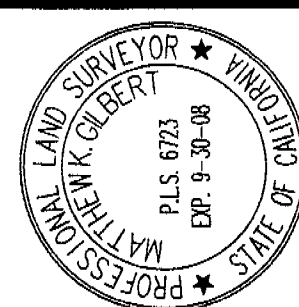

PREPARED BY:
MATTHEW K. GILBERT
Bo7-2449
MATTHEW K. GILBERT, PLS. 6723, EXP. 09/30/08

CITY SET

TOPOGRAPHIC SURVEY
606 E. Avenida San Juan
CITY OF SAN CLEMENTE

PROJECT NUMBER
N/A

DATE
February 20, 2007

SCALE
1" = 8'

SHEET
1
OF 1